

## Apply Wound Packing Gauze & Compress

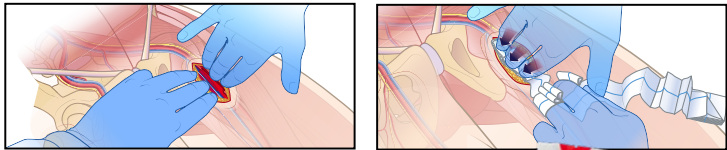

1. Find bleeding source and apply direct pressure.
2. Fill entire wound with gauze while maintaining constant pressure.
3. Hold pressure until first responders arrive.



## Responder Emergency Trauma Dressing (ETD)

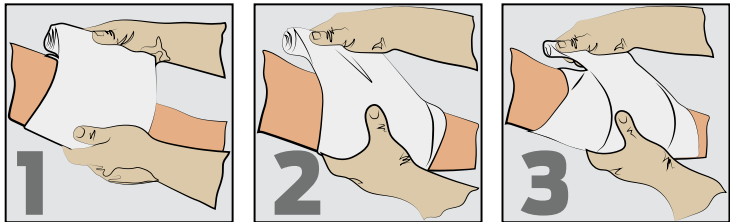

**Place Pad  
over the  
Wound**

**Wrap around  
the Limb,  
covering the  
pad**

**Pull ETD Firmly,  
and continue to  
Wrap,** covering  
the wound  
completely

**Secure with  
velcro  
style fastener**  
when wrap is  
complete



## Open Chest Wound

Apply HyFin® Chest Seal (*Intermediate & Advanced Kits*)

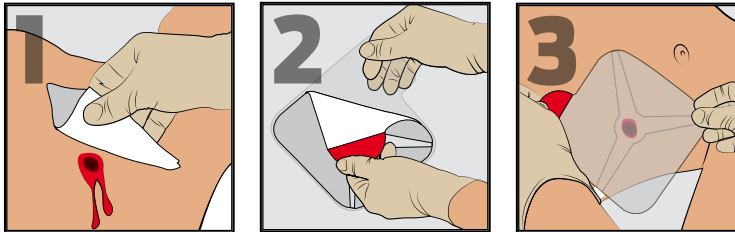

Wipe Wound with gauze

Peel Seal from Backing  
using Red Tab

Center over wound

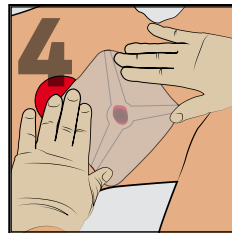

Firmly Press onto skin



## Wrap Survival Blanket

1. Place the blanket over the patient
2. Tuck the edges in
3. Ensure that breathing is not inhibited

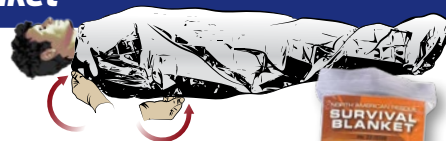

# INSTRUCTIONS FOR USE

P U B L I C  
A C C E S S

# BLEEDING CONTROL



**NORTH AMERICAN RESCUE®**  
www.NARescue.com • 888.689.6277

35 Tedwall Ct. • Greer SC 29650 • USA

# Major Bleeding on Arm or Leg Apply C-A-T® Tourniquet



OR



OR

**TWO-HANDED APPLICATION**  
Route the band around the limb, **pass the red tip through the slit of the buckle**, and position the C-A-T® 2-3" above the bleeding site directly to the skin.\*

**ONE-HANDED APPLICATION**  
**Insert the injured limb through the loop** in the band and position the C-A-T® 2-3" above the bleeding site directly to the skin.\*



**Pull band tightly** and fasten it back on itself all the way around the limb, but not over the rod clips.



Band should be tight enough that **tips of three (3) fingers CANNOT be slid between the band and the limb**. If the tips of three (3) fingers slide under band, retighten and re-secure.



**Twist the rod** until bleeding has stopped.



**Secure the rod inside a clip** to lock it in place. Check for bleeding and distal pulse. If bleeding is not controlled, or distal pulse is present, consider additional tightening or applying a second C-A-T® above and side-by-side to the first. Reassess.

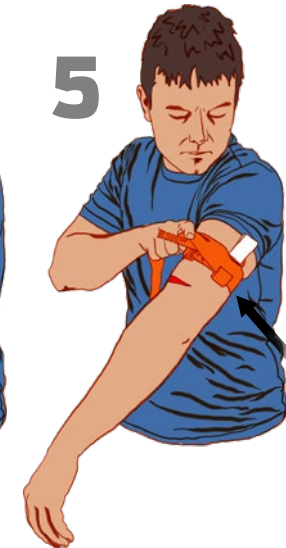

**Route the band** between the clips and over the rod. **Secure rod and band with TIME strap**. Record time of application.

\*If you cannot be sure or cannot take the additional time to examine where the bleeding is coming from based on the situation, the C-A-T® can be effectively applied over clothing as high on the arm or leg as possible. The C-A-T® must NOT be applied over solid objects within the clothing. As soon as the situation permits, the injured limb should be evaluated and the C-A-T® re-positioned 2"-3" above the injury directly to the skin.